

John Allen

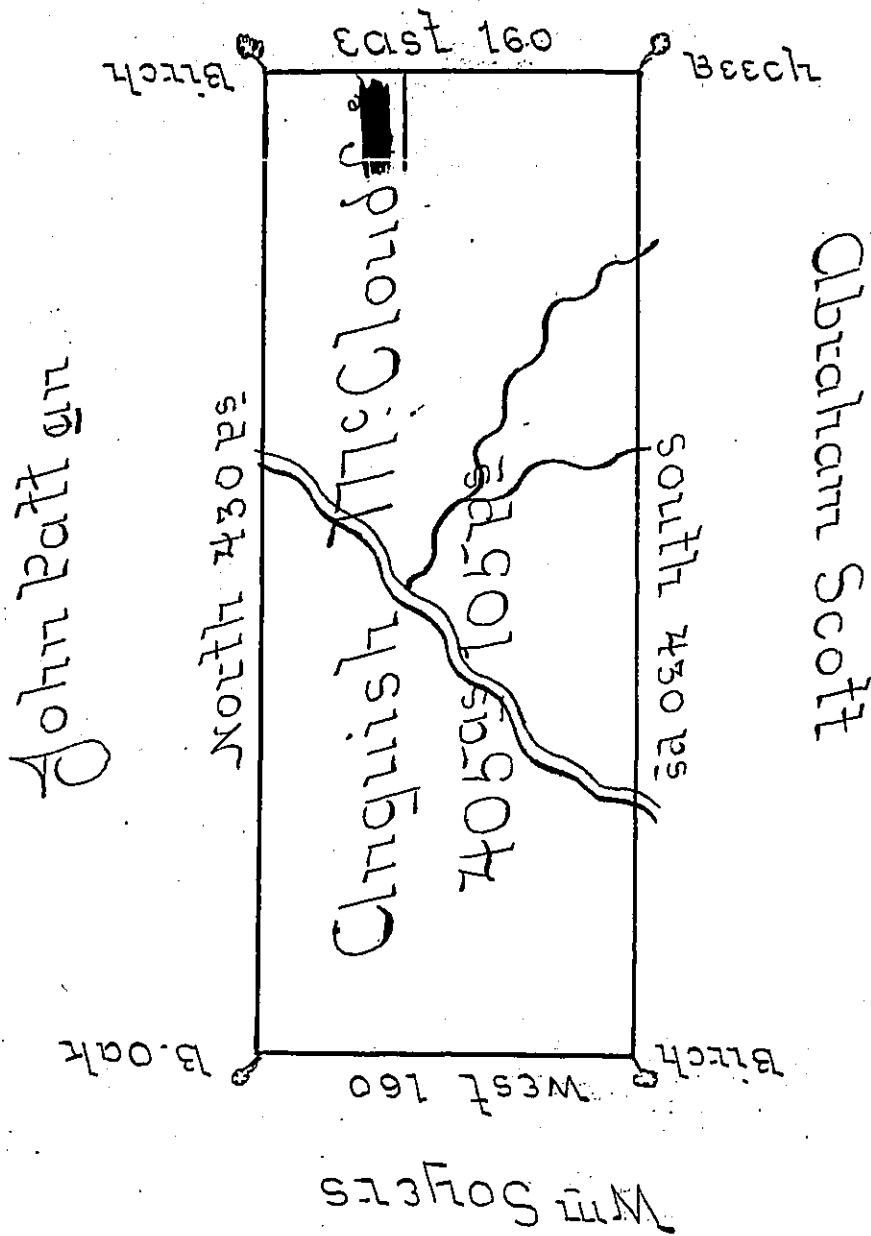

Situated on the Waters of Black Lick Creek in Wheatfield Township, Westmoreland County, containing 405 Acres & 105 Perches and allowance for Roads &c^a surveyed for Anquish McCloud the 24 day of November 1794. on warrant dated the 3 day of May 1793.

James Ross U.S.

To Daniel Broadhead Esq: S^y.

IN TESTIMONY that the above is a copy of the original remaining on file in the Department of Internal Affairs of Pennsylvania, made conformably to an Act of Assembly approved the 16th day of February, 1833, I have hereunto set my Hand and caused the Seal of said Department to be affixed at Harrisburg, this fourth day of March 1902.

James W. Fatta
 Secretary of Internal Affairs.